

Kool



Without heater



Opening heights of up to 3.5m



Features

- Specially designed to be installed on doors of cold stores and freezers.
- Self-supporting casing construction made of zinc plated steel, finished in structural epoxy-polyester RAL 9016 as standard. Other colours or stainless steel construction are available on request.
- Low noise centrifugal double inlet fans driven by an external rotor motor with built in thermal protection contact. Provided with five speed selection.
- Perforated inlet grille with large absorbing surface to minimize the air pressure drop. It doesn't need filter.
- Also available with flat micro-perforated inlet grille, more elegant, for commercial doors where heating is not needed.
- Anodised aluminium blow-out vanes, airfoil shaped, adjustable from 0 to 15° each side.
- Control panel and 20m of telephonic cable with fast connectors type RJ45 (Plug & Play) included.
- Optional: Interface to connect to BMS.

Air curtain type	Airflow m³/h	Fans power input 230V-50Hz (kW)	Fans current 230V-50Hz (A)	Noise level (dB(A))	Weight (kg)
KS 1000 A	1300	0.372	1.68	53	29
KS 1500 A	1950	0.558	2.52	54	44
KS 2000 A	2600	0.744	3.36	55	53
KS 1500 A	3250	0.930	4.20	56	55
KM 1000 A	1850	0.510	2.22	54	29
KM 1500 A	2775	0.765	3.33	55	44
KM 2000 A	3700	1.020	4.44	56	53
KM 1500 A	4625	1.275	5.55	57	55
KG 1000 A	2775	0.765	3.33	55	33
KG 1500 A	3700	1.020	4.44	56	49
KG 2000 A	5550	1.530	6.66	57	63
KG 1500 A	6475	1.785	7.77	58	65

Without air curtain

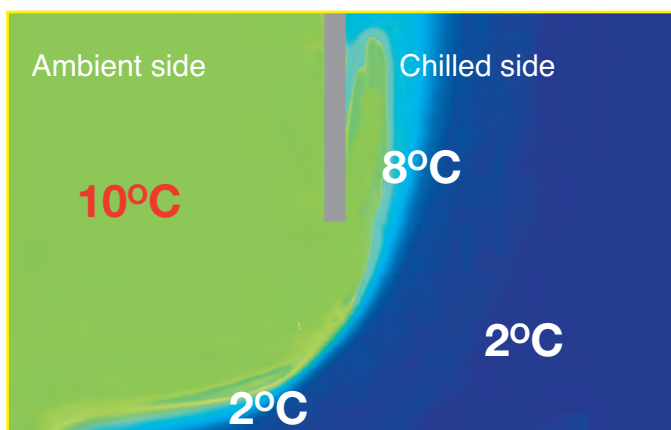

With air curtain

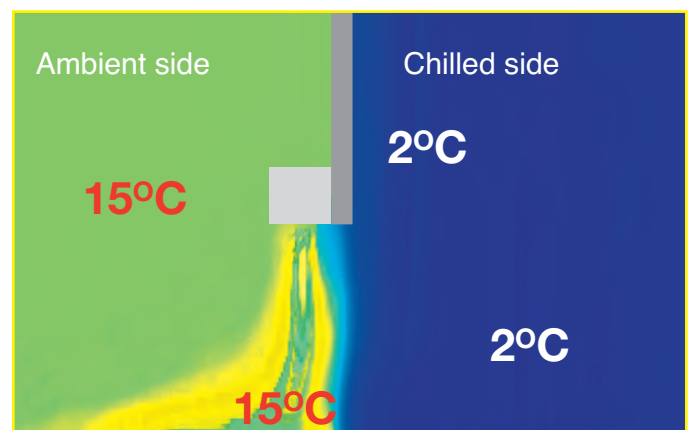

Kool

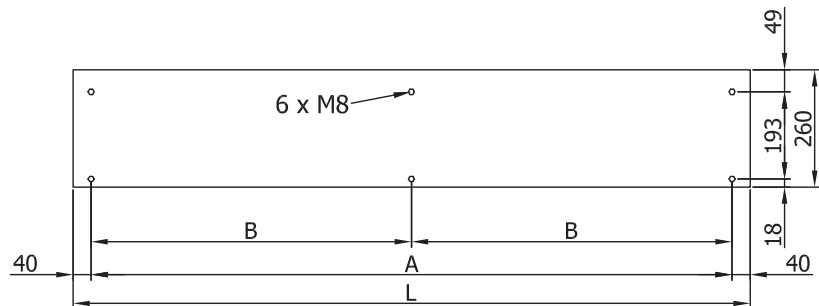
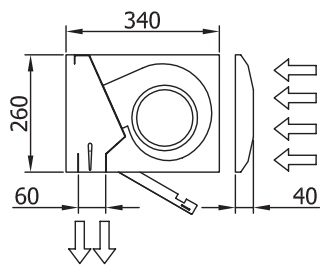
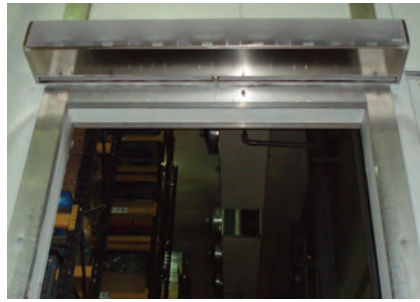

L	A	B
1000	920	-
1500	1420	710
2000	1920	960
2500	2420	1210

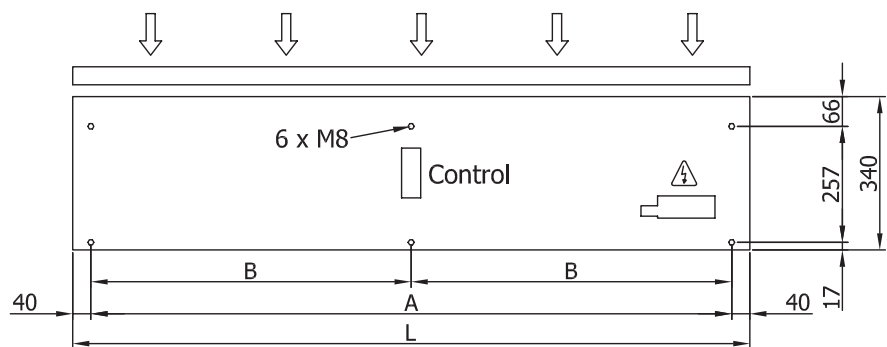

www.jsaircurtains.com

JS has a policy of continually improving products and performance. Actual specifications might vary from those shown.

JS Air Curtains

Artex Avenue, Rustington, LITTLEHAMPTON,
West Sussex, BN16 3LN, UK.

Tel: +44 (0)1903 858656 • Fax: +44 (0)1903 850345

Email: sales@jsaircurtains.com



Part of the JS Humidifiers Group



JS Air Curtains

